

Roof Material	Max Purlin Span (mm)
Custom Orb™	1800
Spandek™	3000
Stramit Corrugated™	3000
Steelspan 900 G550™	5100
Brownbuilt 900 G550™	4100
Corrugated G550™	2400
For roof profiles not listed please contact your local Sperian office	

Compliance with Fall Protection Standards

If installed as per the instructions the Miller Ladder Grip complies with AS/NZS1891 Part 4 2009 as a Fall Arrest or Restraint Anchorage point.

WARNING

ONLY PROPERLY TRAINED PERSONNEL ARE TO USE THIS EQUIPMENT.

AS/NZS 1891.4.2009 SHOULD BE CONSULTED FOR GUIDANCE ON SELECTION USE AND MAINTENANCE MATTERS

THIS EQUIPMENT MUST NOT BE ALTERED IN ANYWAY

LOW PROFILE LADDER BRACKET / FALL ARREST ANCHOR POINT M1030061

MILLER LADDER GRIP

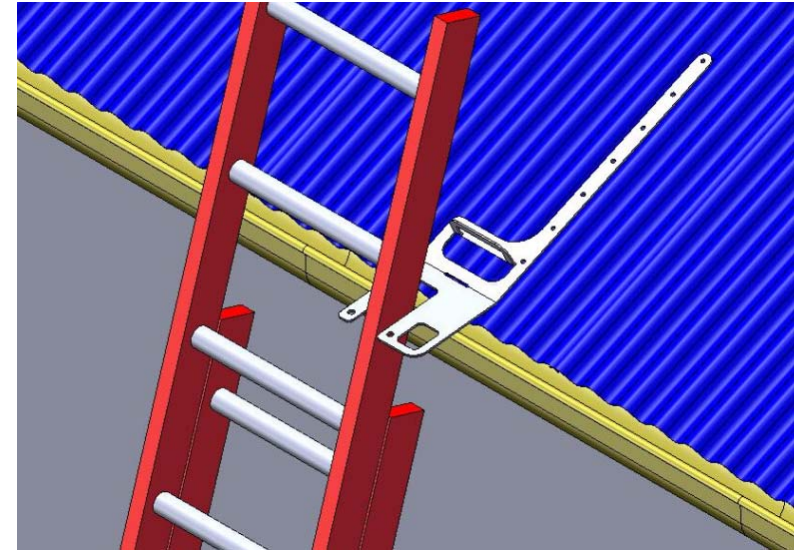

Please note that these instructions are subject to change without prior notice.

Sperian Fall Protection Australia
 Australia Tel: 1300 139 166 New Zealand 0800 322 200
www.sperianprotection.com.au
www.millerfallprotection.com.au

Issue	Date	Note
A	04 Sep 2009	Initial Publication
B	08 Dec 2009	Revision 1

Miller Ladder Grip

The Miller Ladder Grip is to be used to hold the ladder in place while climbing on to roofs.

The unique design of the Miller Ladder Grip provides a Fall Arrest Anchor point to hook on to providing protection while climbing. It also provides a handle to support a person climbing on to the ladder from the roof.

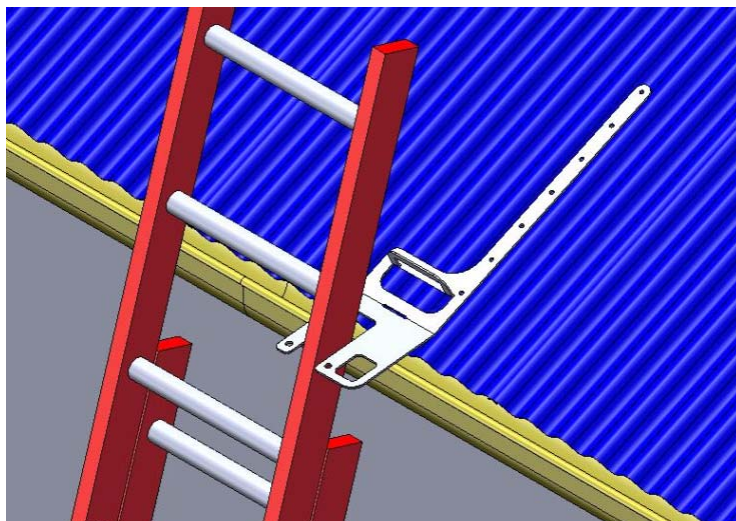

Working at heights is a dangerous practise. The following guidelines are of an inherently general nature and as such they are not a substitute for training, common sense and safe working practises. These fall protection products must only be used in an occupation / workplace where the user receives appropriate training under the respective government workplace legislation or from an approved supplier. For guidance on the use of fall protection equipment, its inspection, location of anchorage points and general fall protection practises we recommend AS/NZS 1891-4-2009 be consulted

General Guidelines

Warning: Do not discard this information; the following instructions should be retained for future reference. The following information must be read & understood, failure to do so could result in serious injury or death. Only properly trained personnel should use this equipment.

The Miller Ladder Grip is designed to be used as a support which prevents the ladder from moving / tipping over. It also provides a Fall Arrest Anchor Point for one person.

1. Rivet only to the ridge of the roofing material.
2. An important part of the Miller Ladder Grip strength is the ability of the roof configuration to withstand the forces being applied to the structure.
3. Care must be taken to only install this unit in situations where the roof and the sub-structure is in good condition.
4. Care must be taken to confirm that all of the required fasteners fixing the roof sheet to the purlins are in place.
5. This product must only be installed and inspected by a "Competent Person" as defined by AS/NZS1891. We recommend a through inspection at least once a year by a competent person.
6. This equipment must not be altered in anyway.
7. The users of this equipment should be aware that forces experienced during the arrest of a fall or prolonged suspension may cause bodily injury.
8. This product is designed for use in normal climatic conditions

In the event of a Miller Ladder Grip sustaining a fall, it is expected that the Bracket and the roof panels will have some distortion, during the energy absorption process. The Miller Ladder Grip is not to be used on metal roofs with a Base Metal Thickness (BMT) less than 0.4 mm.

Fitting Instructions

1. Sit the Miller Ladder Grip on the Roof as shown in the picture
2. Using the Rivets supplied fasten the bracket on to a ridge of the roofing material.

